



**HIGH
RATE
MAX^{XT}**



UPS12-800MRX

Valve Regulated Lead Acid Battery

Designed for UPS Standby Power Applications

FEATURES AND BENEFITS

APPLICATIONS

- Data Centers
- Network Operation Centers
- Industrial Process Control Facilities
- Internet Housing Sites
- Semiconductor Manufacturing
- Banks and Financial Markets
- Power Generation Plants
- Hospital and Testing Laboratories
- Emergency Response Center

- 12-year design life @ 25°C
- Eurobat classification: Long life
- Absorbent Glass Mat (AGM) technology for efficient gas recombination of up to 99% and freedom from electrolyte maintenance
- C&D's Long-Life Alloy having very low calcium levels in the industry -minimizing grid growth, reducing gassing, and extending battery life
- UL Recognized Flame-arresting vents in each cell for safety and long life
- Designed with the same recombination, thermal runaway prevention, gassing and flame-retardant characteristics of the Bellcore 4228 compliant Dynasty Telecom products
- Flame retardant polypropylene case and cover compliant with UL94 V-0
- Proprietary Fixed Orifice Plate Pasting technology applying active materials on both sides of the grid for consistent cell-to-cell performance, higher capacity and uniform grid protection
- Thermally welded case-to-cover bond to eliminate leakage
- Front Access Design, for easy installation and safety maintenance, and space saving
- Not restricted for air transport -Complies with IATA/ICAO Special Provisions A67
- Not restricted for surface transport - Classified as non-hazardous material as related to DOT-CFR Title 49 parts171-189
- Not restricted for water transport -Classified as non-hazardous material per IMDG Amendment 27

Specifications

Cells per Unit	Voltage	Weight	15min WPC@ 1.67EPV	Capacity (C20,1.75V,25°C)	Capacity (C10,1.80V,25°C)	IEC Rating (C10,1.80V, 20°C)	IEC Short Circuit Current	IEC Resistance
6	12V	71 Kg	800 W/cell	226 Ah	210 Ah	203 Ah	5900 Amps	2.4 (mΩ)

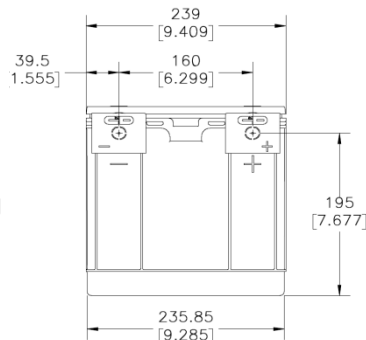
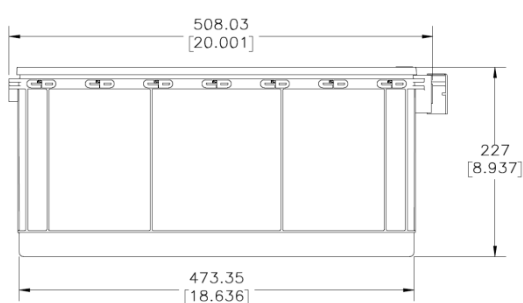
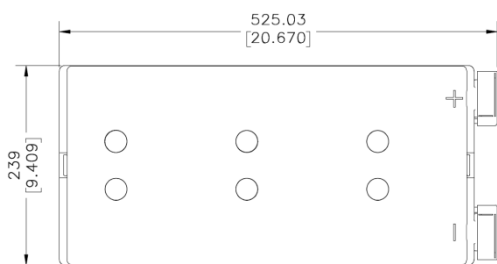

*All dimensions in millimeters and (inches). All dimensions are for reference only. Contact a C&D Representative for complete dimensional information.

Specifications

Operating Temperature Range with temperature compensation	Discharge: -40°F (-40°C) to +160°F (71°C) Charge: -10°F (-23°C) to +140°F (60°C)
Nominal Operating Temperature Range	+74°F (23°C) to +80°F (27°C)
Recommended Maximum Charging Current Limit	C/5 amperes @ 20hr rate
Float Charging Voltage	13.65 ± 0.15 VDC average per 12V unit
Maximum AC Ripple (Charger)	0.5% RMS or 1.5% P-P of float charge voltage recommended for best results. Max voltage allowed = 1.4% RMS (4% P-P), Max current allowed = C/20 A RMS
Self Discharge	Battery can be stored up to 4 months at 77°F (25°C) before a freshening charge is required. Batteries stored at temperatures greater than 77°F (25°C) will require recharge sooner than batteries stored at lower temperatures. See C&D brochure 41-7272, Self-Discharge and Inventory Control for details.
Equalize charge and cycle service voltage	14.40 to 14.80 VDC average per 12V unit @ 77°F (25°C)
Terminal	Threaded copper alloy insert terminal to accept M8 bolt
Terminal Hardware Initial Torque	160 in.-lbs. (18 N-m)

Constant Power Discharge Table - Watts Per Cell @ 25°C (77°F)

Operating Time to End Point Voltage

EPV	5 min	10 min	15 min	20 min	25 min	26 min	30 min	45 min	60 min	90 min	2 hr	3 hr	4 hr	5 hr	8 hr	10 hr	12 hr	20 hr
1.85	862.3	786.7	662.6	556.3	477.9	468.6	422.5	320.9	261.5	195.0	158.3	114.1	89.6	74.4	49.8	40.9	34.7	21.7
1.80	1120.1	907.8	744.0	618.1	526.2	515.3	462.1	348.1	282.0	208.6	168.4	120.9	94.5	78.0	51.9	42.5	36.1	22.7
1.75	1263.6	955.7	776.8	644.6	548.1	536.7	481.0	360.6	291.2	213.7	171.6	123.5	96.3	79.3	52.8	43.2	36.8	23.1
1.70	1301.5	983.7	795.5	660.8	562.4	550.8	493.9	369.3	297.6	217.8	174.5	125.2	97.7	80.4	53.6	44.0	37.3	23.4
1.67	1311.2	990.9	800.0	665.9	567.8	556.2	499.3	372.4	299.6	219.2	175.7	125.9	98.2	81.0	53.9	44.3	37.5	23.6
1.65	1320.6	996.2	805.7	670.4	571.4	559.7	502.3	374.3	300.9	220.1	176.4	126.3	98.6	81.4	54.2	44.5	37.7	23.6

Constant Current Discharge Table - Amps @ 25°C (77°F)

Operating Time to End Point Voltage

EPV	5 min	10 min	15 min	30 min	60 min	90 min	2 hr	3 hr	4 hr	5 hr	6 hr	7 hr	8 hr	10 hr	12 hr	20 hr	24 hr
1.90	312.1	303.3	271.9	189.0	123.1	91.0	73.4	53.0	41.5	34.3	29.1	25.4	22.6	18.5	15.7	9.9	8.3
1.85	455.7	399.1	329.6	214.7	135.7	100.1	80.6	58.2	45.7	37.6	31.9	27.7	24.6	20.1	17.0	10.6	8.9
1.80	599.4	473.4	371.5	231.7	143.2	105.7	85.2	61.6	48.0	39.4	33.4	29.0	25.7	21.0	17.8	11.1	9.3
1.75	690.7	506.2	401.1	239.8	146.5	108.2	87.3	63.0	49.1	40.4	34.2	29.7	26.3	21.5	18.2	11.3	9.5

Note: Batteries to be mounted with 0.5 in. (1.25 cm) spacing minimum and free air ventilation. Specifications subject to change without notification.